

Taconic Crossings

1351 Route 55 - Town of LaGrange

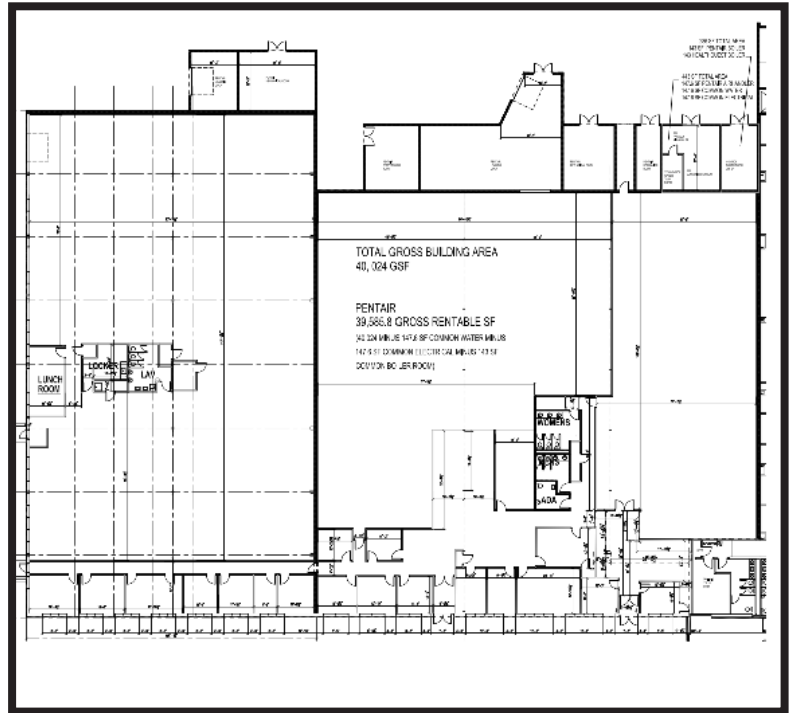

Page Park Associates is a real estate company, specializing in the acquisition, development, management and leasing of commercial properties throughout the Hudson Valley. Page Park Associates uses innovative ideas and has quickly become a leader in the commercial leasing industry.

845 471 0191
jason@pageparkassociates.com
www.pageparkassociates.com

Poughkeepsie Journal Building
85 Civic Center Plaza
Suite LL2
Poughkeepsie, NY 12601

Immediate availability of a 40,000 square foot facility, of which 8,000 square feet is recently renovated office space, 16,000 square feet of 16' height space and 16,000 square feet off 22' height space, with two (2) above grade docks and one (1) at grade dock. There are over one hundred (100) parking spaces. Taconic Crossings is located in the Town of Lagrange, just ¼ mile from the Taconic State Parkway, Route 55 Poughkeepsie Exit.